











Quick Guide – GH1 F

- The ceiling hoist is switched on by pressing one of the buttons on the hand control.
- If the hoist does not switch on, this may be because the emergency stop has been activated.
- Attach the travelling trolley anchor with cord to the locking mechanism at the top of the hoist. Press the  button on the top of the hand control. The button will illuminate when in installation mode. For activating the installation press briefly on . Wait for a long continuous beep confirming that installation is complete. When GH1 F is locked in the travelling trolley press  again to stop installation mode. The hoist can now be used for lifting using the  and .
- For deinstallation of the hoist, choose the  and press briefly the  to activate. Wait until the cord is fully extended before releasing the hoist anchor. Press  again to complete deinstallation mode.
- The hoist can be recharged by inserting the hand control in the charging station placed on the transport trolley. The hand control should always be inserted in the charging station when not in use. The power supply must be connected and switched on.
- The hoist's maximum lifting capacity will be marked on the hoist, e.g., 255 kg/560 lbs. Note that the rail system or the sling may have a lower lifting capacity. The lowest lifting capacity may not be exceeded.
- For further information see the GH1 F user manual.

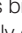

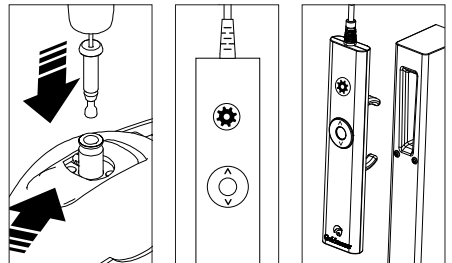
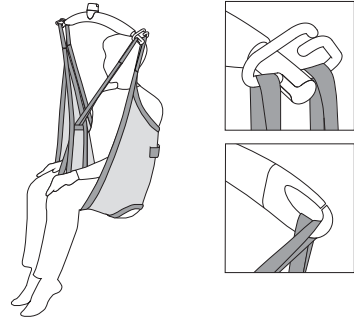
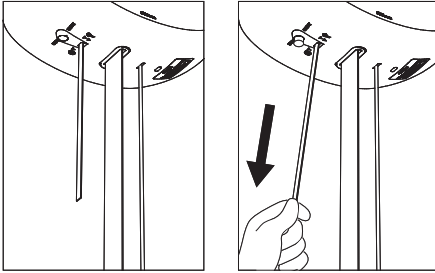

Safety functions

Emergency stop

- One pull on the red strap. Use only in emergencies, when there is an immediate need to stop the hoist.
- When the emergency stop is activated, only the hoist's emergency lowering device will function.
- Deactivate the emergency stop by pressing the "stop" button (yellow button) on the hoist. Then press one of the buttons on the hand control unit twice.

Emergency lowering device

This is activated by a prolonged pull on the red strap. Use only in an emergency. This function allows the patient to be lowered when the hoist has failed to work.



Scan here for user manual, etc. concerning use of the GH1 F.

Accessories

Lifting hanger

Place the sling straps in the hooks. Check that the straps have been correctly attached to the hanger.

Lifting sling

We recommend using a lifting sling with two or four loop attachments for attaching the sling to the lifting hanger. The sling must always correspond with the hoist's lifting capacity. In case of doubt concerning the use of a lifting sling, please contact your supplier.

Daily cleaning and maintenance

Clean with a damp cloth and ordinary detergent. Do not use strong acids, bases or alcohol when cleaning. See user manual.

| Time to care |

For Sales or Customer Service please contact:

Goldmann Inc. - (800) 664-8834